

Load rating per cam roller

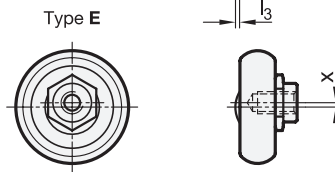
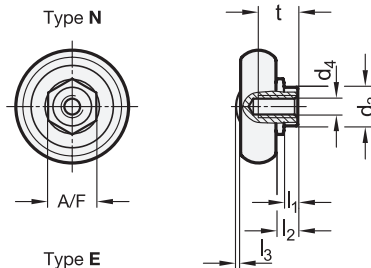
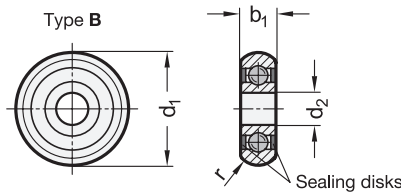
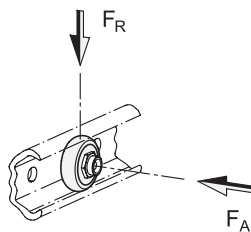

SS Stainless Steel

2 Type

- B** Cam roller with bore
- N** Normal cam roller with centered bearing pivot
- E** Eccentric cam roller with eccentric bearing pivot

4 Coding

- X** For fixed bearing guide rail

Metric table

1

Dimensions in: millimeters - inches

h₁ Rails GN 2492	b₁	b₂	d₁ -0.05	d₂ -0.008	d₃ -0.05	d₄	l₁	l₂	l₃ max.	r	A/F	t	x	F_R per cam roller	F_A per cam roller
30 <i>1.18</i>	7 <i>0.28</i>	10 <i>0.39</i>	22.5 <i>0.886</i>	7 <i>0.2756</i>	10 <i>0.394</i>	M 5	2.6 <i>0.10</i>	4.8 <i>0.19</i>	0.5 <i>0.02</i>	4.5 <i>0.18</i>	13 <i>0.51</i>	8.5 <i>0.33</i>	0.6 <i>0.02</i>	580 N <i>130 lbf</i>	140 N <i>31.47 lbf</i>
45 <i>1.77</i>	11 <i>0.43</i>	15.5 <i>0.61</i>	35.1 <i>1.382</i>	10 <i>0.3937</i>	12 <i>0.472</i>	M 6	4.3 <i>0.17</i>	6.8 <i>0.27</i>	1 <i>0.04</i>	7 <i>0.28</i>	15 <i>0.59</i>	12 <i>0.47</i>	0.8 <i>0.03</i>	1980 N <i>445 lbf</i>	500 N <i>112 lbf</i>

Specification

3

- Cam roller
 - Stainless steel AISI 440C
 - Dust and splash water protected
 - Permanent lubrication
Roller bearing grease, FDA compliant, class H1
- Sealing disks
Rubber (NBR), blue **2RS**
- Threaded mounting collar
Stainless steel AISI 316L
- Operating temperature -40 °F to 212 °F
(-40 °C to 100 °C)
- *Plastic Characteristics* → page QVX
- *Stainless Steel Characteristics* → page QVX
- **RoHS compliant**

Accessory

- Open-end wrench GN 2424.1 → page XYZ

Information

GN 2496 cam rollers can be combined with GN 2492 cam roller linear guide rails to build individual and space-saving linear guide rail systems.

The outer surfaces of the cam rollers are spherically shaped so that, in conjunction with the correspondingly shaped rails, there is a precise, linear run across four points of contact. The materials can also be used in aggressive environments that can be found for example in the chemical, pharmaceutical and medical industries.

In combination with the guide rail, the play or initial tension of multiple cam rollers can be determined during assembly by using the adjustable eccentric cam roller (Type E). The required open-end wrench can be ordered separately as GN 2424.1.

Cam rollers can be combined with custom rails provided that the run geometry is matching.

The sealed and permanently lubricated cam rollers guarantee superior running performance and low wear.

see also...

- Assembly and Technical Instructions
(for Cam Roller Linear Guide Rails) → page QVX

How to order

GN2496-45-E-2RS-X

1	Height h₁
2	Type
3	Material of the sealing disks
4	Coding