

Metric

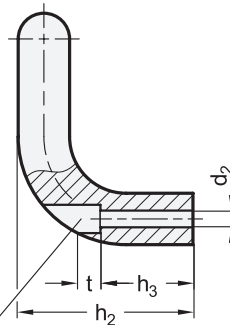

Bore for socket cap screw  
1/4" / 5/16" or  
ISO 4762-M6 / M8

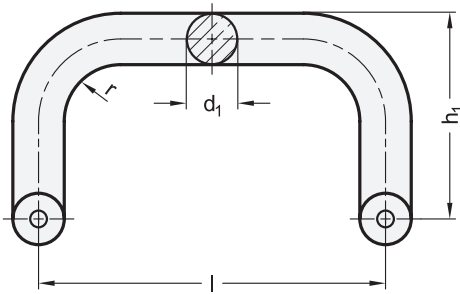

**Metric table**

<sup>2</sup> $d_1$	<sup>3</sup> Length $l$	$d_2$	$h_1 \approx$	$h_2 \approx$	$h_3$	$r$	$t \approx$
20 0.79	200 7.87	6.5 0.26	105 4.13	68 2.68	36 1.42	22 0.87	9 0.35
20 0.79	300 11.81	6.5 0.26	105 4.13	68 2.68	36 1.42	22 0.87	9 0.35
28 1.10	250 9.84	9 0.35	125 4.92	78 3.07	34 1.34	32 1.26	11 0.43
28 1.10	350 13.78	9 0.35	125 4.92	78 3.07	34 1.34	32 1.26	11 0.43
28 1.10	500 19.69	9 0.35	125 4.92	78 3.07	34 1.34	32 1.26	11 0.43

Dimensions in: millimeters / inches

**Specification**

**Aluminum**

- Powder coated
- Black, RAL 9005, textured finish
- Silver, RAL 9006, textured finish
- Plain, tumbled finish

**AL**

- **SW**
- **SR**
- **BL**

RoHS

Cabinet U-handles GN 426.4 are manufactured from a bent aluminum profile.

see also...

	Page
<b>GN 426</b> Cabinet U-Handles (Mounting from the Back)	QVX
<b>GN 426.6</b> Cabinet U-Handles (Offset Round Stainless Steel, Mounting from the Back)	QVX
<b>GN 426.1</b> Cabinet U-Handles (Offset Round Aluminum, Mounting from the Back)	QVX
<b>GN 426.2</b> Cabinet U-Handles (Mounting from the Operator's Side)	QVX
<b>GN 426.5</b> Cabinet U-Handles (Stainless Steel, Mounting from the Back)	QVX

**Technical Information**

Load Capacity Information

QVX

**How to order**

**GN 426.4-AL-20-200-BL**

<sup>1</sup>	<b>Material</b>
<sup>2</sup>	<b>Handle diameter <math>d_1</math></b>
<sup>3</sup>	<b>Length <math>l</math></b>
<sup>4</sup>	<b>Finish</b>