

Type A

Bore for socket cap screw
1/4" / 5/16" or ISO 4762-M6 / M8
hexagon head screw ISO 4014

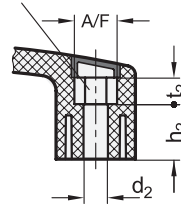

Type B

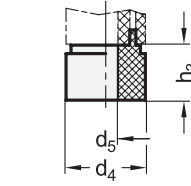

Distance bushing
EN 628.2

Inch | Metric



elesa

Original design EBP / EBP-B



IF product design award

3 Type

- A** Mounting from the back (tapped blind hole)
- B** Mounting from the operator's side

Specification

Handle

- Plastic, Polyamide (PA)
- Glass fiber reinforced
- Operating temperature
-22 °F to 266 °F (-30 °C to +130 °C)
- Black-gray, similar to RAL 7021, matte finish

Tapped insert (Type A)

Brass

Cover cap

- Plastic, Polyamide (PA)
- Black-gray, RAL 7021, matte finish
- Orange, RAL 2004, matte finish
- Gray, RAL 7035, matte finish
- Yellow, RAL 1021, matte finish
- Blue, RAL 5024, matte finish
- Red, RAL 3000, matte finish
- Green, RAL 6017, matte finish

- **DSG**
- **DOR**
- **DGR**
- **DGB**
- **DBL**
- **DRT**
- **DGN**

RoHS

Cabinet U-handles EN 628 are designed with ergonomic shapes to match the Ergostyle product family. They can also be used as complementary handles for cabinet U-handles EN 628.4 and EN 628.5 with power and pneumatic switching function.

The cover caps for type A are supplied ready assembled, for type B they are enclosed loose.

The distance to the screw-on surface can be extended with spacers EN 628.2.

see also...

	Page
EN 628.1 Bridge Handles (Antimicrobial Plastic)	QVX
EN 628.3 Flexible Bridge Handles (Made of Flexible Plastic)	QVX
EN 628.4 Bridge Handles (with Power Switching Function)	QVX
EN 628.5 Bridge Handles (with Pneumatic Switching Function)	QVX

Technical Information

Product Family Ergostyle®	QVX
Strength Values	QVX
Plastic Characteristics	QVX

Accessory

EN 628.2 Spacers	QVX
-------------------------	-----

How to order (Inch)

1	Length l_1
2	Thread d_1
3	Type
4	Color (Cover cap)

EN 628-117-5/16X18-A-DRT

How to order (Metric)

1	Length l_1
2	Thread d_1 (Bore d_2)
3	Type
4	Color (Cover cap)

EN 628-150-8.5-B-DSG

How to order

5	Height h_3
---	--------------

EN 628.2-20.5

1.1
1.2
1.3
1.4
2.1
2.2
2.3
2.4



Inch table

Dimensions in: inches / millimeters

¹ l ₁	² d ₁ Type A	d ₃	d ₄	d ₅	h ₁	⁵ h ₃	l ₂	l ₃ min.	s	t ₁	t ₂
3.70 -0.04 94 -1	1/4 x 20	0.87 22	0.89 22.5	0.26 6.5	1.38 35	0.71 18	4.57 116	2.83 72	0.31 8	0.47 12	0.26 6.5
4.61 ±0.02 117 ±0.5	5/16 x 18	1.02 26	1.04 26.5	0.33 8.5	1.54 39	0.77 19.5	5.63 143	3.58 91	0.33 8.5	0.47 12	0.77 19.5
5.20 ±0.02 132 ±0.5	5/16 x 18	1.06 27	1.04 26.5	0.33 8.5	1.65 42	0.77 19.5	6.26 159	4.13 105	0.37 9.5	0.51 13	0.41 10.5
5.91 ±0.04 150 ±1	5/16 x 18	1.10 28	1.14 29	0.35 9	1.77 45	0.81 20.5	7.09 180	4.80 122	0.37 9.5	0.51 13	0.55 14
7.05 ±0.04 179 ±1	5/16 x 18	1.14 29	1.14 29	0.35 9	2.01 51	0.81 20.5	8.19 208	5.91 150	0.37 9.5	0.51 13	0.63 16

Metric table

Dimensions in: millimeters / inches

¹ l ₁	² d ₁ Type A	d ₂ Type B	d ₃	d ₄	d ₅	h ₁	h ₂	⁵ h ₃	l ₂	l ₃ min.	s	A/F	t ₁	t ₂
94 -1 3.70 -0.04	M 5	-	22 0.87	22.5 0.89	6.5 0.26	35 1.38	-	18 0.71	116 4.57	72 2.83	7.5 0.30	-	10 0.39	-
94 -1 3.70 -0.04	M 6	6.5 0.26	22 0.87	22.5 0.89	6.5 0.26	35 1.38	17 0.67	18 0.71	116 4.57	72 2.83	7.5 0.30	10	12 0.47	6.5 0.26
117 ±0.5 4.61 ±0.02	M 6	6.5 0.26	26 1.02	26.5 1.04	8.5 0.33	39 1.54	7 0.28	19.5 0.77	143 5.63	91 3.58	8.5 0.33	10	12 0.47	19.5 0.77
117 ±0.5 4.61 ±0.02	M 8	8.5 0.33	26 1.02	26.5 1.04	8.5 0.33	39 1.54	18 0.71	19.5 0.77	143 5.63	91 3.58	8.5 0.33	13	13 0.51	8.5 0.33
120 ±0.5 4.72 ±0.02	M 6	6.5 0.26	27 1.06	26.5 1.04	8.5 0.33	40.5 1.59	17.5 0.69	19.5 0.77	147 5.79	93 3.66	9.5 0.37	10	12 0.47	10.5 0.41
120 ±0.5 4.72 ±0.02	M 8	8.5 0.33	27 1.06	26.5 1.04	8.5 0.33	40.5 1.59	17.5 0.69	19.5 0.77	147 5.79	93 3.66	9.5 0.37	13	13 0.51	10.5 0.41
132 ±0.5 5.20 ±0.02	M 6	-	27 1.06	-	-	42 1.65	-	-	159 6.26	105 4.13	9.5 0.37	-	13 0.51	-
132 ±0.5 5.20 ±0.02	M 8	8.5 0.33	27 1.06	26.5 1.04	8.5 0.33	42 1.65	17.5 0.69	19.5 0.77	159 6.26	105 4.13	9.5 0.37	13	13 0.51	10.5 0.41
150 ±1 5.91 ±0.02	M 8	8.5 0.33	28 1.10	29 1.14	9 0.35	45 1.77	18 0.71	20.5 0.81	180 7.09	122 4.80	9.5 0.37	13	13 0.51	14 0.55
179 ±1 7.05 ±0.02	M 8	8.5 0.33	29 1.14	29 1.14	9 0.35	51 2.01	19 0.75	20.5 0.81	208 8.19	150 5.91	9.5 0.37	13	13 0.51	16 0.63
179 ±1 7.05 ±0.02	M 10	-	29 1.14	-	-	51 2.01	-	-	208 8.19	150 5.91	9.5 0.37	-	13 0.51	-